

W	H
4.0	4.0
4.5	4.3
	4.6

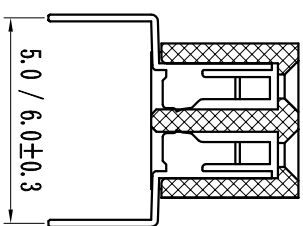

Pin#	尺寸A	尺寸B
2X3	4.0	6.5
2X4	6.0	8.5
2X5	8.0	10.5
2X6	10.0	12.5
2X7	12.0	14.5
2X8	14.0	16.5
2X9	16.0	18.5
2X10	18.0	20.5
2X11	20.0	22.5
2X12	22.0	24.5
2X13	24.0	26.5
2X14	26.0	28.5
2X15	28.0	30.5
2X16	30.0	32.5
2X17	32.0	34.5
2X18	34.0	36.5
2X19	36.0	38.5
2X20	38.0	40.5
2X21	40.0	42.5
2X22	42.0	44.5
2X23	44.0	46.5
2X24	46.0	48.5
2X25	48.0	50.5
2X26	50.0	52.5
2X27	52.0	54.5
2X28	54.0	56.5
2X29	56.0	58.5
2X30	58.0	60.5
2X31	60.0	62.5
2X32	62.0	64.5
2X33	64.0	66.5
2X34	66.0	68.5
2X35	68.0	70.5
2X36	70.0	72.5
2X37	72.0	74.5
2X38	74.0	76.5
2X39	76.0	78.5
2X40	78.0	80.5

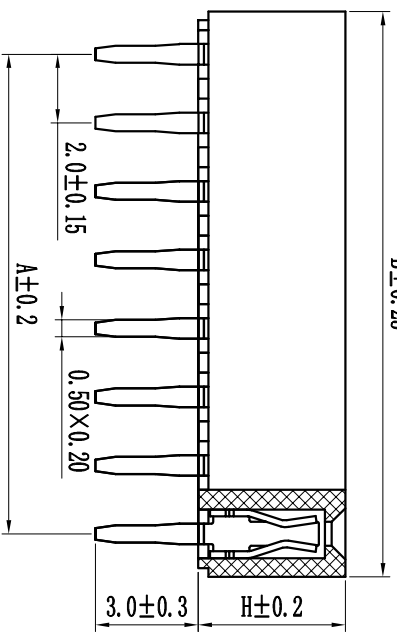
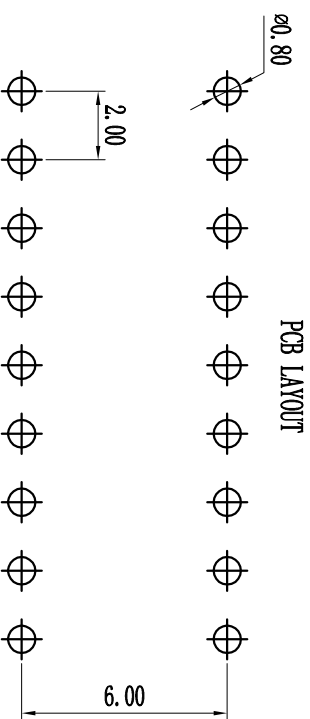

引脚系列	间距	封装	双排	单排	焊盘	材料	角度	端子	备注
c-1	0.5mm		1-单排	1-单排	1*0.5/0.5P	A-10°	S=180°	12.5mm间距25	0-3.0
b-1	1.0mm		2-双排	2-双排	2*0.5/0.5P	B-50°	R=90°	11.0mm间距18	1-3.0/0.6 (双排)
c-1	1.27mm		3-二排	3-二排	3*0.5/0.5P	C-50°	C=160°	12.5mm间距22	2-3.0/3.0 (双排)
d-2	2.0mm		4-四排	4-四排	4*0.5/0.5P	D-100°	D=160°	100-非焊接端子	2-2.8/4.0 (双排)
e-2	2.5mm				5*0.5/0.5P	E-150°	E=135°	100-非焊接端子	2-2.6/3.5 (双排)
f-3	3.0mm				6*0.5/0.5P	F-90°		100-非焊接端子	2-2.6/3.5 (双排)
h-5	5.0mm				10*0.5/0.5P	H-90°		100-非焊接端子	其它另做说明

技术规范:
 额定电流 : 1.5AMP
 适用温度 : -40°C to +105°C
 接触电阻 : 20mΩ Max
 绝缘电阻 : 1000MΩ Min
 耐电压 : AC 500V
 绝缘材料 : Polyester (UL94V-0)
 Standard: PA-6T
 端子材质 : Bronze
 电镀规范 : Au or Sn Over 50u" Ni

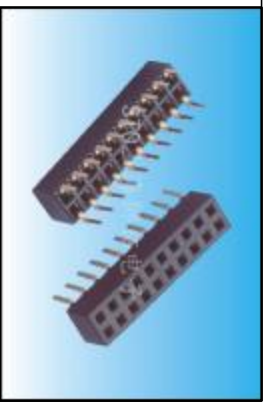

TOLERANCE:
 X ±0.05
 XX ±0.10
 ANG.

STC 上海狮拓电子科技有限公司

THIRD ANGLE PROJECTION

客户确认
 姓名: _____ 日期: _____
 日期: _____ 日期: _____
 承辦 日期: _____
 退回 日期: _____

2.0mm双排母, DIP, 间距4.0/4.3/4.6mm
 Spec: 2.0mm Female Header, Dual Row, DIP
 Positions: 2X3*2X40
 Plastics Height: 4.0/4.3/4.6mm